

CUSTOMER PART No.

CUSTOMER

**CAN ART STD.**

DIE No.

**EH05240**

DESCRIPTION

1 1/4 " SCHEDULE 40 PIPE

PROPOSAL No.

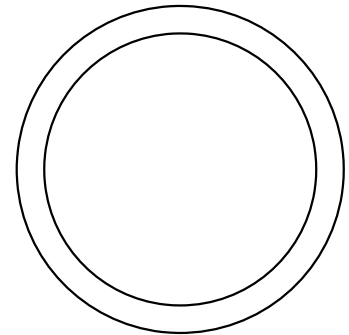
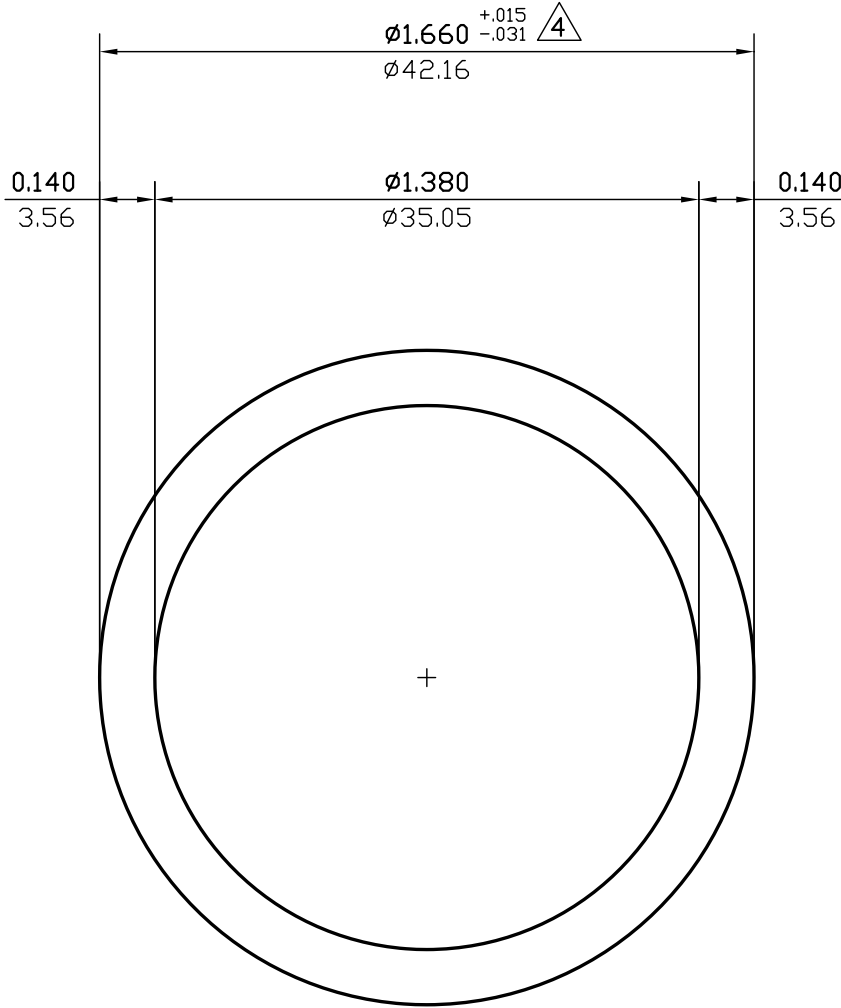

ACTUAL SIZE

WALL THICKNESS 0.140 (3.56) EXCEPT AS SHOWN

DATE	REV	DESCRIPTION	BY		
03/10/23	5	REMOVED EXPOSED SURFACES AND ALLOY	JASON		
07/13/15	4	REVISED TOLERANCE FROM $\pm 0.025$ TO $+0.015/-0.031$ .	PAUL		
EST.AREA	0.669	IN. <sup>2</sup>	EST.AREA	431	MM. <sup>2</sup>
EST.WT.	0.789	LBS/FT.	EST.WT.	1.174	KG/M.
EST.PER.	9.550	IN.	EST.PER.	242.6	MM.
OUT PER.	5.215	IN.	OUT PER.	132.5	MM.
C.C.D.	1.660	IN.	C.C.D.	42	MM.
FACTOR	12	FINISH	M/F	ALLOY & TEMP.	
CKD BY		SCALE	2:1	DWN BY	G.M. DATE 11/20/90

**CAN ART**

ALUMINUM EXTRUSION INC.

85 PARKSHORE DRIVE  
BRAMPTON, ONT L6T 5M1  
TEL. NO. (905) 791-1464  
FAX NO. (905) 791-9151  
E-MAIL: canart@canart.com

THIS DRAWING IS NOT NECESSARILY A COPY OF YOUR ORIGINAL. PLEASE APPROVE DIMENSIONS AND TOLERANCES INDICATED. CAN ART ASSUMES NO RESPONSIBILITY EITHER TECHNICAL OR LEGAL FOR HAVING THIS SHAPE MADE. THE CUSTOMER AGREES TO FULLY PROTECT CAN ART ALUMINUM FROM CLAIMS OF OTHERS RESULTING FROM THIS SHAPE.

SIGNED: \_\_\_\_\_ DATE: \_\_\_\_\_

NOTE: BREAK ALL CORNERS WITH 0.015" (.38 MM) RADIUS UNLESS OTHERWISE NOTED. STANDARD TOLERANCES TO APPLY UNLESS OTHERWISE SPECIFIED.